



**Dear Ashwaubenon Community Members:**

**The Village of Ashwaubenon and the Ashwaubenon School District are partnering to ask your opinion regarding the possibility of upgrading several well-used facilities to better serve our community.**

The projects include the:

- ✓ Ashwaubenon Community Center
- ✓ Ashwaubenon High School/Community Auditorium
- ✓ Ashwaubenon High School/Community Swimming Pool

Ideas and options for some of these projects have been discussed for more than 20 years! To formalize our planning process, the Ashwaubenon Community Facilities Steering Committee was formed last year with representation from the School District, Village and individuals from the community. Detailed information on the work done to date, can be found at both the School District and Village websites:

[www.ashwaubenon.k12.wi.us](http://www.ashwaubenon.k12.wi.us) or [www.ashwaubenon.com](http://www.ashwaubenon.com)

We feel this is a particularly good time to consider our options because interest rates continue to be at historic lows. Also, financing the debt through the Village could significantly reduce the tax impact, which will be explained later in this survey. In addition, there may be efficiencies by combining two or more of the projects.

**While we have heard many ideas, our plans going forward must reflect the priorities of our taxpayers.**

Therefore, we need your input through this community-wide survey. Your responses on this survey will be confidential and returned directly to School Perceptions, an independent Wisconsin-based firm, with expertise in conducting community surveys.

**To save on expenses, we encourage you to take the survey online before **November 25<sup>th</sup>**:**

- 1) Go to the website: **www.survey2000.com**
- 2) Enter the survey access number: **<ID\_Number>**
- 3) Take the survey!

The Survey Access Number will not identify you. It simply ensures that only one survey is completed per person. To receive a second Survey Access Number for another adult in your household, please call the Village Hall at (920) 492.2300 or the School District at (920) 492-2900. If you do not have Internet access, please complete this survey and drop it off at a school office or the Village Hall or mail it to:

School Perceptions  
319 East Washington Street  
Slinger, WI 53086

Final survey results will be reported at a special meeting at the Village Hall located at 2155 Holmgren Way on December 9<sup>th</sup> at 6:00 p.m. Guided by your valued feedback, we will continue to shape the future of the Ashwaubenon community.

Sincerely,  
Mark Williams  
School Board President

Michael W. Aubinger  
Village President

## Respondent Information

What is your age?    18-25    26-35    36-45    46-55    56-64    65+

Do you live in the Village of Ashwaubenon?    Yes    No

Are you an employee of the Ashwaubenon School District?    Yes    No

Are you a parent of an Ashwaubenon School District student?    Yes    No

Are you an employee of the Village of Ashwaubenon?    Yes    No

If you currently have school-aged children, what school(s) do they attend? (Mark all that apply)

- |   |  |
|---|--|
| <input type="checkbox"/> Ashwaubenon School District  | <input type="checkbox"/> Public school outside of District |
| <input type="checkbox"/> West De Pere School District | <input type="checkbox"/> Home-schooled                     |
| <input type="checkbox"/> Private school               | <input type="checkbox"/> Other                             |

If you have children 18 years-old or younger, what are their age(s)? (Mark all that apply)

- 0-3 years-old    4-11 years-old    12-14 years-old    15-18 years-old

How would you like to receive information regarding the facility planning process?

(Mark all that apply)

- |  |   |   |
|--|---|---|
| <input type="checkbox"/> District/Village mailings | <input type="checkbox"/> District/Village website | <input type="checkbox"/> Attend meetings                        |
| <input type="checkbox"/> Email                     | <input type="checkbox"/> Facebook                 | <input type="checkbox"/> Attend District/Village Board meetings |
| <input type="checkbox"/> Newspaper                 | <input type="checkbox"/> Twitter                  |   |
| <input type="checkbox"/> Other:                    |   |   |

Comments/suggestions to improve communication:

(Optional) If you would like to receive future updates regarding the Village/District facility planning process, please provide us with your contact information:

Name:

Email:

Mailing address:

***(This information will not be connected to your survey responses)***

## Funding Options

Taxpayers may be asked to consider approval of a referendum to finance one or more of the proposed facility projects. Financing through the School District would cost Ashwaubenon taxpayers 41% more than if the projects were financed through the Village. In fact, because of the current Wisconsin school funding formula, for every \$1.00 financed by the Village, it would cost the taxpayers \$1.41 if financed by the School District.

The table below shows the annual tax impact for various project costs, if financed through the School District as well as the Village. *\*Assumes a 20-year borrowing period, a conservative 4.22% interest*

	<b>Auditorium</b>	<b>Swimming Pool</b>	<b>Community Center</b>
Cost estimate	\$7.5 - \$8.0 million	\$7.0 - \$9.0 million	\$3.5 - \$3.9 million
Annual tax impact per \$100,000 of home value if <b>financed through the <u>School District</u></b>	Up to \$41.00/Yr	Up to \$45.00/Yr	N/A
Annual tax impact per \$100,000 of home value if <b>financed through the <u>Village</u></b>	Up to \$29.00/Yr	Up to \$32.00/Yr	Up to \$14.00/Yr
<i>Reduced annual tax impact if financed through the Village (per \$100,000 of home value)</i>	<b>(\$12.00/Yr)</b>	<b>(\$13.00/Yr)</b>	N/A
<i>Total reduced tax impact community-wide, if financed through the Village</i>	<b>\$3.1 - \$3.3 million</b>	<b>\$2.9 - \$3.7 million</b>	N/A
<b>If any project was supported by referendum, whom would you prefer financing the project(s)?</b>	<input type="checkbox"/> Village of Ashwaubenon <input type="checkbox"/> Ashwaubenon School District <input type="checkbox"/> Not sure/need more information		

**Comments/questions/suggestions regarding project funding:**

## Ashwaubenon High School Auditorium

At 48 years old, this facility has exceeded its expected life. The auditorium only holds 440 spectators, even though the student population has more than doubled since its original construction in 1965. The auditorium is too small for a community of our size and is in need of significant repair. This space is used more frequently than any classroom: for performing arts and music events, extra-curricular activities, tournaments, workshops, meetings and community presentations. Last year, individual performer and spectator use exceeded 52,000 visits. A facility use analysis, confirmed by Bray Architects, identified significant concerns:

### Safety Concerns

- Scenery must be constructed on-stage, creating restricted access and a hazardous environment
- Mezzanine access and most lighting apparatus are restricted due to OSHA walkway non-compliance
- Ventilation and air quality concerns exist during hot days with a full audience
- Does not meet current Americans with Disabilities Act (ADA) accessibility standards
- No wheelchair seating and limited handicap access in audience seats

### Space/Feature Deficiencies

- Stage and audience seating are significantly smaller than needed to hold the large number of performers and audience members for an all AHS-band concert, a combined Choral/Band concert and many student and community events (i.e. Jazz Fest), as evidenced by the facility outsourcing that occurs
- No orchestra pit, meeting room, light and sound booths, scenery fly rigging, limited space at sides of stage, storage space and only one dressing room, all of which are required for any community performance uses

What is being proposed? (The diagram below is a preliminary concept)

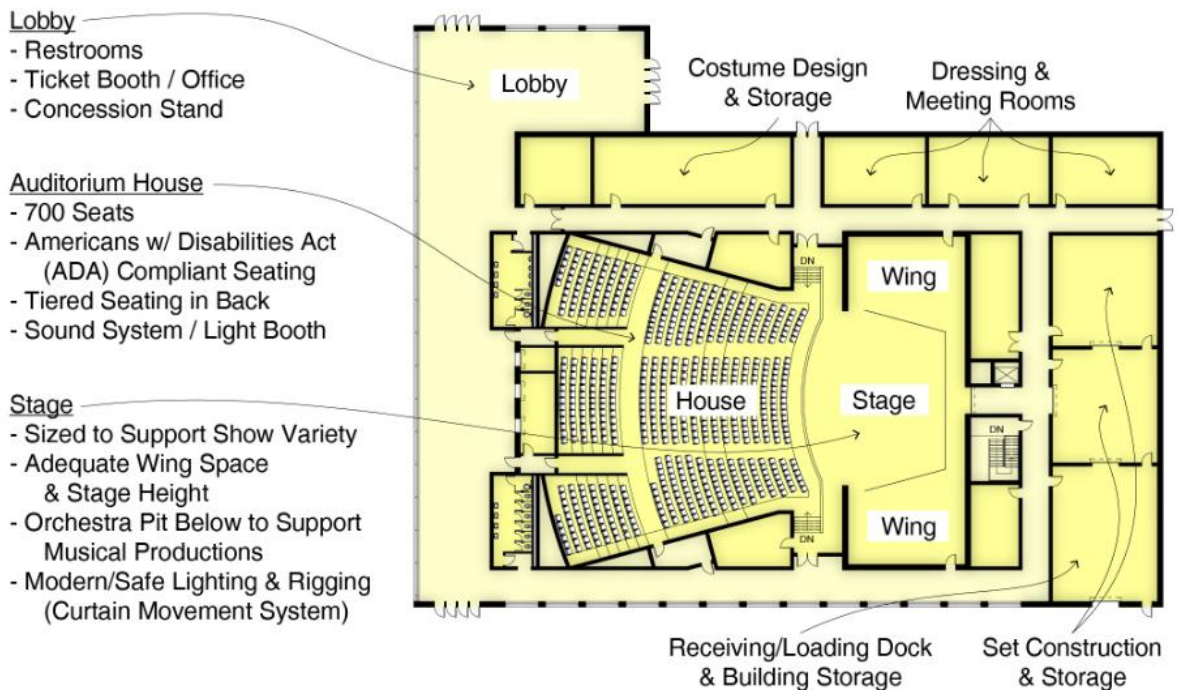

**Would you likely support a \$7.5 - \$8.0 million referendum to build a new High School/Community Auditorium?**

Representing an estimated annual tax impact of \$27 - \$29 for every \$100,000 of property value assuming the Village finances this option

*\*Assumes a 20-year borrowing period, a conservative 4.22% interest*

- Definitely yes
- Probably yes
- Undecided
- Probably no
- Definitely no

**\*\* Comments can be made on the final page of the survey.**

## Ashwaubenon High School Swimming Pool

The Ashwaubenon High School and the Ashwaubenon community share the swimming pool. AHS uses the pool for the Boys and Girls Swim Teams and physical education classes. The Village uses the pool for swim clubs, various park and recreation programming, including the ability for Ashwaubenon residents to rent the pool for birthday parties, outings, etc. The pool is open more than 16 hours per day year-round. Last year, individual swimming pool and spectator use exceeded 54,000 visits.

At 48 years old, the pool is not energy efficient and has exceeded its expected life. Because of its age, repair and service are much more complicated and costly. Handicap and senior citizen accessibility is difficult. Due to the size of the pool and surrounding space, programming is severely limited. Consequently, the facility is unable to serve the whole community including water exercise, senior citizens groups and lessons. The pool has only five lanes, making it too small to host high school invitational and state/regional tournament meets.

**What is being proposed? (The diagram below is a preliminary concept)**

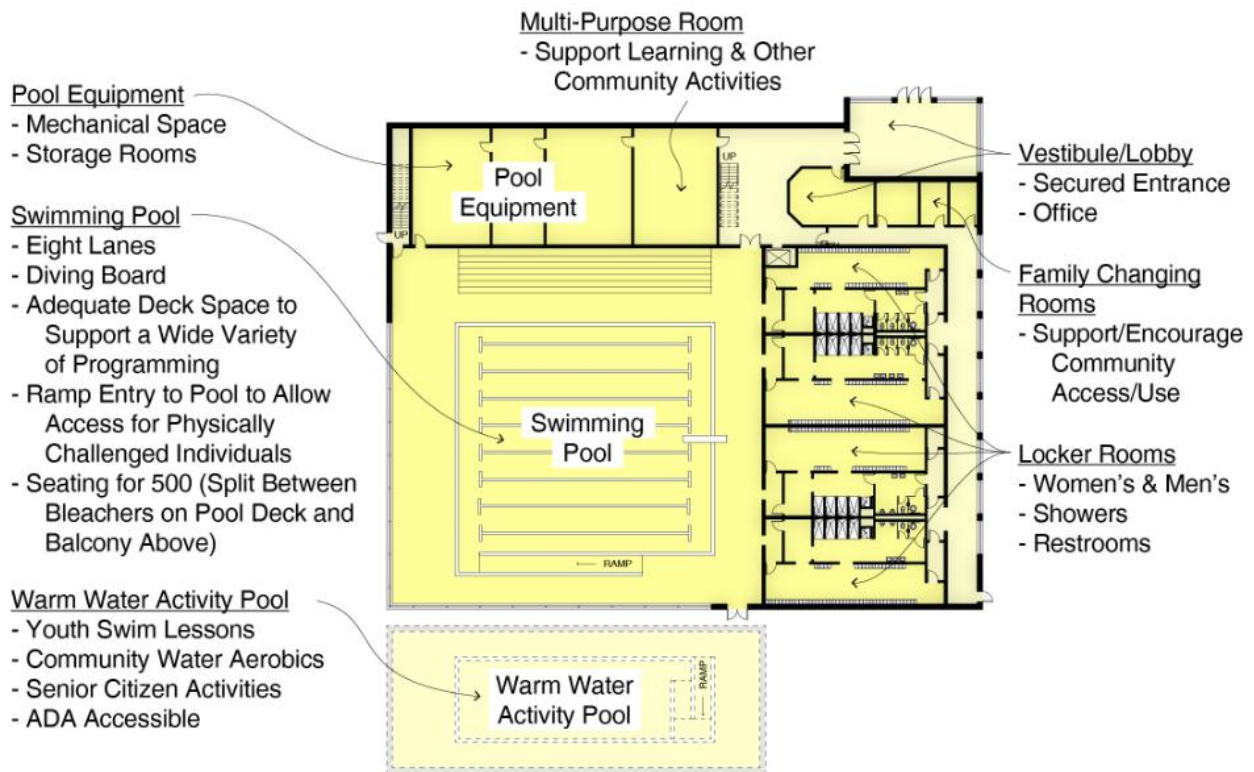

<p><b>Would you likely support a \$7.0 - \$7.5 million referendum to build a new High School/Community swimming pool?</b></p> <p>Representing an estimated annual tax impact of \$25 - \$27 for every \$100,000 of property value assuming the Village finances this option  <i>*Assumes a 20-year borrowing period, a conservative 4.22% interest</i></p>	<p><input type="checkbox"/> Definitely yes</p> <p><input type="checkbox"/> Probably yes</p> <p><input type="checkbox"/> Undecided</p> <p><input type="checkbox"/> Probably no</p> <p><input type="checkbox"/> Definitely no</p>
<p><b>Would you likely support an additional \$1.5 million to expand this pool project to include a second smaller pool for warm water activities?</b></p> <p>Representing an <u>additional</u> estimated annual tax impact of \$5 for every \$100,000 of property value assuming the Village finances this option  <i>*Assumes a 20-year borrowing period, a conservative 4.22% interest</i></p>	<p><input type="checkbox"/> Definitely yes</p> <p><input type="checkbox"/> Probably yes</p> <p><input type="checkbox"/> Undecided</p> <p><input type="checkbox"/> Probably no</p> <p><input type="checkbox"/> Definitely no</p>

**\*\* Comments can be made on the final page of the survey.**

## Ashwaubenon Community Center

The Community Center is used annually by more than 25,000 people. Last year, 429 rental/use agreements were issued to individuals, clubs and organizations of all sizes including the VFW, youth sports, graduation/birthday/wedding parties and the local technical college. The Center accommodates Village-run classes and programs, senior citizen events and is used as a gathering place for many walks, runs and community events. However, due to capacity constraints and scheduling conflicts, many Village groups are denied use.

The Community Center has been operated by the Village since 1968, and can only be rented by Ashwaubenon residents or organizations which benefit the Ashwaubenon community. The center is 5,800 square feet which includes 3,800 square feet of usable meeting space. Seating capacity is limited to 150 for the front of the building and 60 in the back. The remaining space is for offices, storage, kitchen and restrooms. Inadequate room size and aging facility conditions have deterred rentals.

At 44 years old, the Center's meeting rooms, restrooms and kitchen have become outdated and worn. To support large groups, the kitchen needs commercial sinks and appliances. The original 1968 boiler is in need of constant repair and is costing the Village maintenance dollars. A WPS energy audit found the facilities' heating/ventilation system very inefficient. Uncontrolled temperature variations occur, and WPS recommends replacing the boiler and air-conditioning system to reduce ongoing operational costs. A facility use analysis also identified the need to upgrade restrooms to meet Americans with Disabilities Act (ADA) accessibility standards.

### What is being proposed? (The diagram below is a preliminary concept)

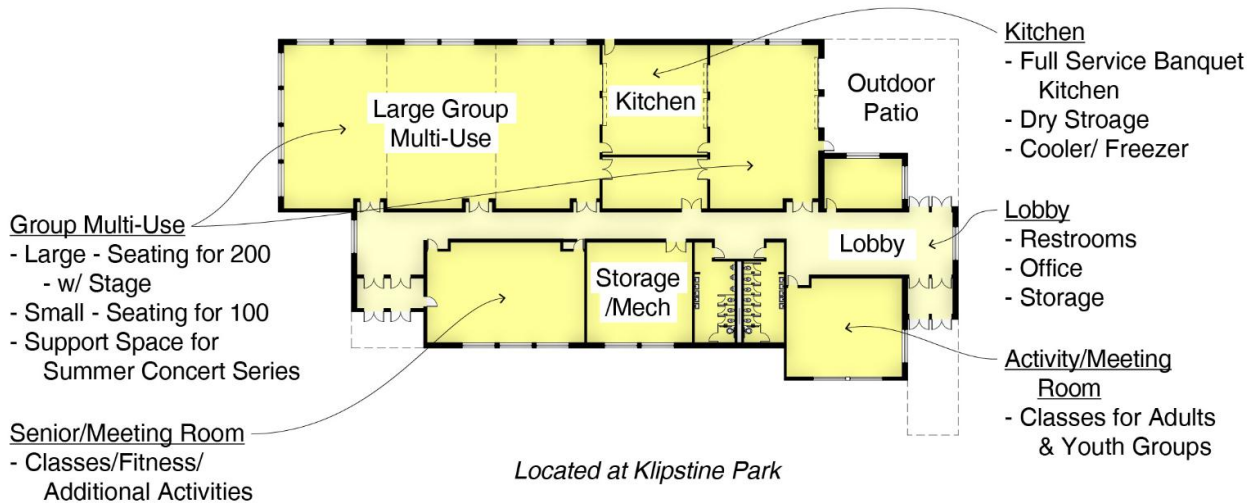

### Would you likely support a \$3.5 - \$3.9 million referendum to build a new community center?

Representing an estimated annual tax impact of \$13 - \$14 for every \$100,000 of property value assuming the Village finances this option

\*Assumes a 20-year borrowing period, a conservative 4.22% interest

- Definitely yes
- Probably yes
- Undecided
- Probably no
- Definitely no

\*\* Comments can be made on the final page of the survey.

**Comments/suggestions regarding the Ashwaubenon High School Auditorium:**

**Comments/suggestions regarding the Ashwaubenon High School Swimming Pool:**

**Comments/suggestions regarding the Ashwaubenon Community Center:**

Ashwaubenon School District  
1055 Griffiths Ln  
Green Bay, WI 54304

PRSR STD  
ECRWSS  
U.S. POSTAGE  
PAID  
EDDM RETAIL??



*Important Ashwaubenon  
Community Survey  
Enclosed*

***Please complete the survey by mail or online  
before November 11<sup>th</sup>.***

***We need your input!***